

The Madison County Election Commission has determined a need for 33 additional precinct scanners, 10 ballot tote bins, 14 ballot marking devices (including case), and related equipment installation and freight.

This equipment is needed for the upcoming November 2020 election. Therefore, time is of the essence in approving and making this purchase.

Purchase of the items determined to be needed constitute a commodity purchase. State Law requires that such be purchased using reverse auction procedures. This will create a 45-day period before the Board could enter into a purchase agreement – giving less than two weeks for delivery and setup for the November election.

Madison County has received confirmation that the Secretary of State's Office has approved use of HAVA (Help America Vote) Funds for this purchase.

After research for, and consideration of, vendors that could supply such equipment, Madison County made a request for quotes from the following vendors:

- Voting Works
- Hart Intercivic
- Dominion voting
- Smartmatic
- Election Systems and Software (ES&S)

Using the contact information on Dominion Voting's website, the request for a quote was rejected.

The remaining four vendors submitted a response to our request.

Voting Works – This vendor does not provide a system that is similar to our current election processes. Therefore, an entire replacement and restructuring of our election system would be required. To completely replace our current system with a Voting Works system is estimated to cost \$623,397.

Hart Intercivic – This vendor does utilize a methodology that is similar to our current election processes. However, the equipment does not interface with our existing equipment or software. To utilize this equipment would require a group of precincts to use a new system while others continued to use our existing system. Additionally, the final vote tally would be accumulated by two systems and then manually combined. To place this equipment in service as a second election system, is estimated to cost \$380,586.00.

Smartmatic – This vendor expressed an interest in quoting a solution but declined as they could not have a solution ready the November 2020 election.

Election Systems and Software (ES&S) – This vendor quotes the additional equipment at \$221,686.50. ES&S has provided a letter indicating that they sell proprietary equipment and software. This does not remove the requirement from competitive bidding.

To approve an emergency purchase under our COVID-19 Emergency Declaration, please consider the following and find that:

1. To respond to the lingering impact of COVID-19, a situation beyond the control of Madison County, additional equipment (precinct scanners, tote bins, and ballot marking devices) is needed to facilitate appropriate social distancing in voting precincts.
2. The time required to advertise for and conduct a reverse auction creates a situation where the resulting equipment purchase cannot occur in time to improve voting conditions at the November 2020 election.
3. Madison County has made reasonable efforts to obtain competitive bids for the equipment being purchased.
4. Selecting equipment provided by another vendor will create confusion for poll workers and citizens, as there is no ability to interface with the existing election systems.
5. Purchasing equipment from the current vendor, who is the lowest and best quote, is the only option available to support and improve voting processes for the November 2020 election,

Therefore, Madison County should initiate an emergency purchase of 33 precinct scanners, 10 tote bins, and 14 ballot marking devices from ES&S. And, if approved, the Purchase Clerk is authorized to issue a Purchase Order for such equipment.



Michael Watson
SECRETARY OF STATE

June 23, 2020

The Honorable Pat Truesdale
Madison County Election Commission
P.O. Box 608
Canton, MS 39046

Dear Ms. Truesdale,

The Secretary of State's Office has received and reviewed Madison County's HAVA Grant Application seeking approval of its purchase of the following:

- 50 Green Rolling Bags – Denied
- 33 DS200 Precinct Scanners – Approved
- 14 ExpressVote Ballot Marking Devices – Approved

We cannot approve the purchase of the ballot bag per EAC guidance as they do not relate to upgrades to election technology, specifically to Federal Election, or election security. Finding some of the intended expenditures to be allowable under the Help America Vote Act, our office approves Madison County's HAVA Application in the amount of \$233,021.50.

Madison County has \$134,430.15 remaining in the county's 2018 HAVA allotment and \$168,516.13. Reimbursement will exhaust your 2018 allotment, and the remaining balance will be paid from 2020.

After making the approved expenditures, please submit your receipt(s) and evidence of payment so we may reimburse Madison County for these HAVA expenditures. If you have any questions, do not hesitate to contact me at (601) 359-6360 or Hawley.Robertson@sos.ms.gov.

Sincerely,

Hawley R. Robertson
Assistant Secretary of State, Elections Division

2020 HAVA Grant Application Form

<p>Form</p> <p>A</p>

County: MADISON COUNTY 5/27/2020

Person Completing Application: PAT TRUESDALE

Title/Position: ELECTION COMMISSIONER

Phone Number: 601-613-7203

Fax Number: _____

Email: pat.truesdale@madison-co.com

IT Contact Name: DUANE THOMPSON

IT Contact Phone Number: 601-855-5508 Email: duane.thompson@

madison-co.com

Table A: Total Grant Request

A	B	C
Grant Area	Details and Proposed Date of Purchase	Proposed Cost
Voting Equipment, purchase	VENDOR: ES&S 33 DS-200 PCT SCANNERS (\$189,750) AND 14 EXPRESSVOTE (BMD \$46,550); 10 SOFT SIDE CASES (\$2450); 10 DS-200 BALLOT	\$ 212,136.50
Voting Equipment, maintenance or upgrade	EQUIPMENT INSTALLATION + SHIPPING & HANDLING INCLUDING \$28,863.50 DISCOUNT.	\$ 9550.00
Enhancement of Election Technology	ANNUAL POST-WARRANTY HARDWARE MAINT + SUPPORT FEE; EXTENDED WARRANTY & FIRMWARE LICENSES DS-200s AND	\$ 11,335.00
Post-Election Auditing		\$
Cyber Security		\$
ADA Polling Place Improvements Total		\$
TOTAL		\$233,021.50

Shelton Vance

From: Shelton Vance
Sent: Wednesday, August 19, 2020 1:18 PM
To: 'charlie@voting.works'
Subject: Election Equipment

Is it possible for you to provide me with an estimate of what it would cost to implement the following setup with your company's equipment.

33 precinct ballot scanners (similar to ES&S DS200) with backup batter and memory device

10 Tote Bins

14 Ballot Marking Devices and carrying case

I am aware that your system does not interface with ES&S equipment. Further, I understand that your quote must include the equipment and software that will accumulate and report results from the precinct scanners.

Thank you for your assistance. Please advise of any questions that you may have.

Shelton

Shelton Vance, CPA
County Administrator
Madison County
PO Box 608
Canton, MS 39046
601-855-5502 (voice)
601-855-5875 (fax)

Shelton Vance

From: Shelton Vance
Sent: Wednesday, August 19, 2020 1:17 PM
To: 'sales@hartic.com'
Subject: Election Equipment

Is it possible for you to provide me with an estimate of what it would cost to implement the following setup with your company's equipment.

33 precinct ballot scanners (similar to ES&S DS200) with backup batter and memory device

10 Tote Bins

14 Ballot Marking Devices and carrying case

I am aware that your system does not interface with ES&S equipment. Further, I understand that your quote must include the equipment and software that will accumulate and report results from the precinct scanners.

Thank you for your assistance. Please advise of any questions that you may have.

Shelton

Shelton Vance, CPA
County Administrator
Madison County
PO Box 608
Canton, MS 39046
601-855-5502 (voice)
601-855-5875 (fax)

Shelton Vance

From: Shelton Vance
Sent: Wednesday, August 19, 2020 1:19 PM
To: 'sales@dominionvoting.com'
Subject: Election Equipment

Is it possible for you to provide me with an estimate of what it would cost to implement the following setup with your company's equipment.

33 precinct ballot scanners (similar to ES&S DS200) with backup batter and memory device

10 Tote Bins

14 Ballot Marking Devices and carrying case

I am aware that your system does not interface with ES&S equipment. Further, I understand that your quote must include the equipment and software that will accumulate and report results from the precinct scanners.

Thank you for your assistance. Please advise of any questions that you may have.

Shelton

Shelton Vance, CPA
County Administrator
Madison County
PO Box 608
Canton, MS 39046
601-855-5502 (voice)
601-855-5875 (fax)

Shelton Vance

From: Shelton Vance
Sent: Wednesday, August 19, 2020 2:58 PM
To: 'Spence Flatgard'
Subject: RE: Election Vendor Contacts

Requests sent to two. Dominion's e-mail bounces back saying that they will not accept my message.

SV

From: Spence Flatgard <sflatgard@watkinseager.com>
Sent: Wednesday, August 19, 2020 9:17 AM
To: Shelton Vance <Shelton.Vance@madison-co.com>
Subject: Election Vendor Contacts

CAUTION! External Content. Please use caution when opening attachments and links. Do not provide your username and password if requested.

Good morning, Shelton. Following up on contact information for other election equipment vendors. As I understand it, the 3 largest vendors in the U.S. are: ES&S, Dominion and Hart Interactive. I think that two or three may have bid on election equipment in Madison County about three years ago when we made our purchase. Also, Voting Works became a vendor in Mississippi after we purchased our equipment. Their representative for Mississippi is Charlie Munford who can be reached at charlie@voting.works and his cell number is (504) 717-0884. He has reached out to Supervisor Baxter, Commissioner Julia Hodges and me.

Hart Intercivic's contact information for sales can be found at: <https://www.hartintercivic.com/our-company/about-hart/>

Voting Solutions Sales

sales@hartic.com
800.223.4278 (Option #2)

Dominion's contact information for sales can be found at <https://www.dominionvoting.com/contact>
This weblink has an entry to send emails to their sales department and their telephone number is 1.866.654.8683.

I don't know if this list include one of the vendors that you had contacted previously, but I hope this is useful. Please let me know if there is anything else that would be helpful for me to follow up on.

And thanks for your help! Spence

Spence Flatgard

WATKINS & EAGER PLLC

400 East Capitol Street

Jackson, Mississippi 39201

601.965.1888 Office Direct

601.672.5917 Cell

www.watkinseager.com

The information transmitted is intended for viewing only by the addressee, and may contain confidential and/or privileged material. Any review, retransmission, dissemination or other use of, or taking of any action in reliance upon, this information by persons or entities other than the intended recipient is prohibited. If you have received this message and you are not the intended recipient, please contact the sender at 601-965-1900 and delete the material immediately and do not retain a copy.

Shelton Vance

From: postmaster@domvoting.onmicrosoft.com
To: 'sales@dominionvoting.com'
Sent: Wednesday, August 19, 2020 1:19 PM
Subject: Undeliverable: Election Equipment



Your message to sales@dominionvoting.com couldn't be delivered.

The group sales only accepts messages from people in its organization or on its allowed senders list, and your email address isn't on the list.

shelton.vance	Office 365	sales
Sender		Action Required
Sender not allowed		

How to Fix It

It appears you aren't in the same organization as the group (or a sub-group) you're sending to or your email address isn't on the group's allowed senders list. Ask the owner of the group to grant you permission to send to it, and then try again. If the group belongs to a different organization than yours, contact the organization's customer service department for assistance. If the group is in your organization and you don't know who the group owner is, you can find it by doing the following in either Outlook on the web or Outlook:

- Open your Sent folder and select the original message.
- If you're using Outlook on the web, select the group name located on the To or CC line. If you're using Outlook, double-click the group name located on the To or CC line.
- In Outlook on the web, from the pop-up dialog box, choose Owner. In Outlook, choose Contact. The owner's name is listed under Owner.

The owner of the group may have intentionally chosen to restrict who can send messages to it, and they may not want to adjust the existing restriction. In this case, you'll have to contact the group members by

some other means, such as sending an email message to their individual email addresses or contacting them by phone.

Was this helpful? [Send feedback to Microsoft.](#)

More Info for Email Admins

Status code: 550 5.7.133

This error occurs when the distribution group, security group, or Microsoft 365 group is configured to accept messages only from authenticated senders (senders in the same organization or those added to the group's allowed senders list).

To fix the issue, the recipient's email admin or the group owner must add the sender's email address to the group's allowed senders list or change the group's delivery management setting to accept messages from senders inside and outside of the organization.

Usually this issue can only be fixed by the recipient's email admin or the group owner.

For more information and steps to fix this error, see [Fix email delivery issues for error code 5.7.133 in Office 365](#).

Original Message Details

Created Date: 8/19/2020 6:18:55 PM
Sender Address: shelton.vance@madison-co.com
Recipient Address: sales@dominionvoting.com
Subject: Election Equipment

Error Details

Reported error: *550 5.7.133 RESOLVER.RST.SenderNotAuthenticatedForGroup; authentication required; Delivery restriction check failed because the sender was not authenticated when sending to this group*
DSN generated by: CH2PR13MB3478.namprd13.prod.outlook.com

Message Hops

HOP	TIME (UTC)	FROM	TO	WITH
1	8/19/2020 6:18:55 PM	JANDC000-MBN14.ventech.com	JANDC000-MBN14.ventech.com	mapi
2	8/19/2020 6:18:55 PM	JANDC000-MBN14.ventech.com	JANDC000-MBN15.ventech.com	Microsoft SMTP
3	8/19/2020 6:18:56 PM	JANDC000-MBN15.ventech.com	JANDC000-HUB04.ventech.com	Microsoft SMTP

4	8/19/2020 6:18:59 PM	JANDC000-HUB04.ventech.com	outbound2.ventech.com	SMTP
5	8/19/2020 6:18:59 PM	outbound2.ventech.com	jandc-zix01.ventech.com	ESMTPS
6	8/19/2020 6:19:00 PM	127.0.0.1	Outbound.ventech.com	SMTP
7	8/19/2020 6:19:01 PM	jandc-zix01.ventech.com	DM6NAM10FT028.mail.protection.outlook.com	Microsoft SMTP cipher=TLS_ECD
8	8/19/2020 6:19:01 PM	DM6NAM10FT028.eop- nam10.prod.protection.outlook.com	DM5PR20CA0009.outlook.office365.com	Microsoft SMTP cipher=TLS_ECD
9	8/19/2020 6:19:01 PM	DM5PR20CA0009.namprd20.prod.outlook.com	CH2PR13MB3478.namprd13.prod.outlook.com	Microsoft SMTP cipher=TLS_ECD

Original Message Headers

Received: from DM5PR20CA0009.namprd20.prod.outlook.com (2603:10b6:3:93::19) by CH2PR13MB3478.namprd13.prod.outlook.com (2603:10b6:610:29::16) with Microsoft SMTP Server (version=TLS1_2, cipher=TLS_ECDHE_RSA_WITH_AES_256_GCM_SHA384) id 15.20.3305.16; Wed, 19 Aug 2020 18:19:01 +0000

Received: from DM6NAM10FT028.eop-nam10.prod.protection.outlook.com (2603:10b6:3:93:cafe::92) by DM5PR20CA0009.outlook.office365.com (2603:10b6:3:93::19) with Microsoft SMTP Server (version=TLS1_2, cipher=TLS_ECDHE_RSA_WITH_AES_256_GCM_SHA384) id 15.20.3305.25 via Frontend Transport; Wed, 19 Aug 2020 18:19:01 +0000

Authentication-Results: spf=pass (sender IP is 68.216.178.89) smtp.mailfrom=madison-co.com; dominionvoting.com; dkim=none (message not signed) header.d=none; dominionvoting.com; dmarc=bestguesspass action=none header.from=madison-co.com;

Received-SPF: Pass (protection.outlook.com: domain of madison-co.com designates 68.216.178.89 as permitted sender) receiver=protection.outlook.com; client-ip=68.216.178.89; helo=jandc-zix01.ventech.com;

Received: from jandc-zix01.ventech.com (68.216.178.89) by DM6NAM10FT028.mail.protection.outlook.com (10.13.152.240) with Microsoft SMTP Server (version=TLS1_2, cipher=TLS_ECDHE_RSA_WITH_AES_256_GCM_SHA384) id 15.20.3305.24 via Frontend Transport; Wed, 19 Aug 2020 18:19:01 +0000

Received: from 127.0.0.1 (ZixVPM [127.0.0.1]) by Outbound.ventech.com (Proprietary) with SMTP id D59662C72DF for <sales@dominionvoting.com>; Wed, 19 Aug 2020 13:19:00 -0500 (CDT)

Received: from outbound2.ventech.com (unknown [10.180.1.103]) (using TLSv1.2 with cipher ECDHE-RSA-AES256-GCM-SHA384 (256/256 bits)) (No client certificate requested) by jandc-zix01.ventech.com (Proprietary) with ESMTPS id 4B1FD2C72B7 for <sales@dominionvoting.com>; Wed, 19 Aug 2020 13:18:59 -0500 (CDT)

X-AuditID: 0ab40166-91dff700000009d7-c5-5f3d6d105392

Received: from JANDC000-HUB04.ventech.com (jandc000-hub04.ventech.com [10.225.2.38])
 (using TLS with cipher ECDHE-RSA-AES128-SHA256 (128/128 bits))
 (Client did not present a certificate)
 by outbound2.ventech.com (Symantec Messaging Gateway) with SMTP id
AA.5F.02519.01D6D3F5; Wed, 19 Aug 2020 13:18:59 -0500 (CDT)

Received: from JANDC000-MBN15.ventech.com (10.225.2.87) by
 JANDC000-HUB04.ventech.com (10.225.2.38) with Microsoft SMTP Server (TLS) id
14.3.487.0; Wed, 19 Aug 2020 13:18:56 -0500

Received: from JANDC000-MBN14.ventech.com (10.225.2.86) by
 JANDC000-MBN15.ventech.com (10.225.2.87) with Microsoft SMTP Server (TLS) id
15.0.1497.2; Wed, 19 Aug 2020 13:18:55 -0500

Received: from JANDC000-MBN14.ventech.com ([10.225.255.132]) by
 JANDC000-MBN14.ventech.com ([10.225.255.132]) with mapi id 15.00.1497.000;
 Wed, 19 Aug 2020 13:18:55 -0500

From: Shelton Vance <Shelton.Vance@madison-co.com>
To: "'sales@dominionvoting.com'" <sales@dominionvoting.com>
Subject: Election Equipment
Thread-Topic: Election Equipment
Thread-Index: AdZ2VRVXf6asa58CQ0On37byY8dGew==
Date: Wed, 19 Aug 2020 18:18:55 +0000
Message-ID: <bd4737a4f2b342dc891bc3cfe7ea045e@JANDC000-MBN14.ventech.com>
Accept-Language: en-US
Content-Language: en-US
X-MS-Has-Attach:
X-MS-TNEF-Correlator:
z-ms-exchange-transport-fromentityheader: Hosted
x-originating-ip: [10.225.2.8]
Content-Type: multipart/alternative;
 boundary="_000_bd4737a4f2b342dc891bc3cfe7ea045eJANDC000MBN14ventechcom_"
MIME-Version: 1.0
X-VPM-MSG-ID: ab2339d3-7cac-4236-afff-abcd4f132855
X-VPM-HOST: jandc-zix01.ventech.com
X-VPM-GROUP-ID: dc8b904c-5fc8-4139-9d0c-b94d9cc3796b
X-VPM-ENC-REGIME: Plaintext
X-VPM-IS-HYBRID: 0
Return-Path: shelton.vance@madison-co.com
X-EOPAttributedMessage: 0
X-EOPTenantAttributedMessage: a6825ce9-1545-419a-a7d5-fbe5d70d06f6:0
X-MS-PublicTrafficType: Email
X-MS-Office365-Filtering-Correlation-Id: a2b1cab7-d1fb-4a40-cb8e-08d8446c5912
X-MS-TrafficTypeDiagnostic: CH2FR13MB3478:



COMPANY

SERVICES

DOMINION
DIFFERENCE

We recognize how important communication is to our customers. We price available to our current and prospective customers, ensuring that their ne satisfactory manner. As part of our continuing commitment to customer s your feedback, thoughts or questions using the form below.

DOMINION VOTING
1.866.654.VOTE (8683)

SALES

UPGRADES

SERVICING

MEDIA CONTACT



IF YOU
TO COM
DIRECT
or to arrang
please prov

NAME*

EMAIL*

PHONE*

TITLE

COMPANY

HOW CAN
WE HELP
YOU?*

*MANDATE

I'm not :

Learn more
about the

**DOMINION
DIFFERENCE**

Learn more
about our

PRODUCTS

Learn more about
our experiences

IN THE FIE

©2014 Dominion Voting Systems. All rights reserved

Shelton Vance

From: Charlie Munford <charlie@voting.works>
Sent: Tuesday, August 25, 2020 9:42 AM
To: Shelton Vance; Matt Pasternack
Subject: Re: Election Equipment
Attachments: Madison County Universal BMD - Sheet1.pdf

CAUTION! External Content. Please use caution when opening attachments and links. Do not provide your username and password if requested.

Hi Mr. Vance,

We have prepared a spreadsheet for you outlining some of the costs of our equipment and a view of how this might map onto your precincts. This worksheet is in no way a final quote for a voting system, but it may give you some price comparison to begin your analysis.

One important fact to understand in interpreting this worksheet is that VotingWorks does not currently make a precinct scanner equivalent to the DS200, or tote bins. We do make Ballot-Marking Devices (BMDs), and these go with the Encoders and Printer Stations quoted in the sheet. The option envisioned in this quote is that all voters (except absentee and affidavit ballot voters) would vote on BMDs which are ADA compliant, and print their ballots on the Printer Stations. The Printer Station gives a preliminary vote total result at the precinct for mounting on the wall at the precinct, but the official results would be tabulated when the paper ballots are scanned back at election central at the courthouse.

VotingWorks will be building a precinct scanner in 2021, and at that time it would be possible for you to compare our precinct scanner to the DS200 directly. We expect to achieve a favorably competitive price.

This is a quote of precinct equipment only. The cost of the equipment to be used at the courthouse for managing the election, printing paper absentee ballots, and scanning the BMD ballots is not quoted here, nor is ongoing TRUST (technology, return, upgrade, support, and training.)

Please let us know if this information meets your current needs.

We appreciate your interest in VotingWorks, and we hope that we can satisfy your desire to improve your voting system in Madison County at an affordable price.

Sincerely,
Charlie

On Wed, Aug 19, 2020 at 1:17 PM Shelton Vance <Shelton.Vance@madison-co.com> wrote:

Is it possible for you to provide me with an estimate of what it would cost to implement the following setup with your company's equipment.

33 precinct ballot scanners (similar to ES&S DS200) with backup batter and memory device

10 Tote Bins

14 Ballot Marking Devices and carrying case

I am aware that your system does not interface with ES&S equipment. Further, I understand that your quote must include the equipment and software that will accumulate and report results from the precinct scanners.

Thank you for your assistance. Please advise of any questions that you may have.

Shelton

Shelton Vance, CPA

County Administrator

Madison County

PO Box 608

Canton, MS 39046

601-855-5502 (voice)

601-855-5875 (fax)

--

Charlie Munford
VotingWorks
504-717-0884 cell
charlie@voting.works

Voting Machines

Our Design Philosophy

Voting should be:

- **Secure.** Voters should have strong confidence that their vote was recorded correctly and that all votes were counted fairly. Voters should not depend on trusting election officials or vendors, VotingWorks included.
- **Affordable.** If voting equipment is too expensive, poor counties suffer, and the system is no longer representative of the will of the people. That's unacceptable.
- **Accessible.** Many millions of voters have some significant disability or sensory/motor impairment that makes casting a secret ballot challenging. We believe providing all Americans, abled or not, with a secure secret ballot is a requirement of the highest order.
- **Delightful.** We can make voting amazing. Voters should leave the polls confident that their vote was correctly recorded, but excited about how pleasant the experience was. And not only voters: poll workers should have a delightful experience, too.

We combine these principles with **pragmatism**: no system can be perfect on any one principle without deeply compromising others, so we look to design a system that is the best combination of strong — if imperfect — solutions to each of these challenges.

Paper Ballots & Risk-Limiting Audits

The two critical design pillars of our voting system are:

- Voter-verifiable paper ballots.
- Performing risk-limiting audits to confirm election outcome.

As we explore ways to improve voting, these two pillars will remain invariant.

Open Source

All of our source code is available on [GitHub](#).

County	Precinct	2019 - Hoseman	2019 - Hughes	2019 - Total	BMD (\$1490)	Encoder (\$826)	Printer Station (\$1213)	Total Retail Cost - Universal BMD
Madison	Highland Colony	1982	680	2662	18	3	3	\$32,937.00
Madison	Parkway Pentec	1929	554	2483	17	3	3	\$31,447.00
Madison	Ridgeland Recre	1343	1009	2352	16	2	2	\$27,918.00
Madison	Fellowship Bible	1374	827	2201	15	2	2	\$26,428.00
Madison	Lake Caroline Cl	1662	284	1946	13	2	2	\$23,448.00
Madison	Madison Cultural	1300	459	1759	12	2	2	\$21,958.00
Madison	Vertical Church	1145	408	1553	10	2	2	\$18,978.00
Madison	Trace Ridge Bap	946	499	1445	10	2	2	\$18,978.00
Madison	Victory Christian	1182	253	1435	10	2	2	\$18,978.00
Madison	Greater Mt Levi F	1049	305	1354	9	2	2	\$17,488.00
Madison	New Life Baptist	1012	218	1230	8	2	2	\$15,998.00
Madison	Ridgel'D 1st Metl	745	460	1205	8	2	2	\$15,998.00
Madison	Colonial Heights	918	222	1140	8	2	2	\$15,998.00
Madison	Canto St. Paul M	479	602	1081	7	2	2	\$14,508.00
Madison	Canton Fire Stati	159	793	952	6	2	2	\$13,018.00
Madison	Twin Lakes Bapti	643	303	946	6	2	2	\$13,018.00
Madison	Franklin Baptist C	617	278	895	6	2	2	\$13,018.00
Madison	Victory Baptist Cl	638	176	814	5	2	2	\$11,528.00
Madison	Canton Catholic	234	563	797	5	2	2	\$11,528.00
Madison	Magnolia Heights	241	528	769	5	2	2	\$11,528.00
Madison	Fairview MB Chu	330	392	722	5	2	2	\$11,528.00
Madison	Canton Andersor	57	612	669	4	2	2	\$10,038.00
Madison	Northbay Bayvie	489	151	640	4	2	2	\$10,038.00
Madison	Gluckstadt @ St	234	373	607	4	2	2	\$10,038.00
Madison	Pleasant Gift Bap	272	281	553	4	2	2	\$10,038.00
Madison	Camden Commu	92	412	504	3	2	2	\$8,548.00
Madison	First Presbyteriar	80	418	498	3	2	2	\$8,548.00
Madison	Mark Apartments	192	300	492	3	2	2	\$8,548.00
Madison	Pleasant Green f	85	367	452	3	2	2	\$8,548.00

Madison	Mad. Co. Baptist	29	421	450	3	2	2	\$8,548.00
Madison	Sunnybrook Reti	295	79	374	2	2	2	\$7,058.00
Madison	Canton National	84	187	271	2	2	2	\$7,058.00
Madison	Mt. Hope M.B. Cl	211	43	254	2	2	2	\$7,058.00
Madison	Canton Bible Ch	22	216	238	2	2	2	\$7,058.00
Madison	Canton South Lit	91	114	205	2	2	2	\$7,058.00
Madison	Cedar Grove Ba	13	98	111	2	2	2	\$7,058.00
Madison	China Grove A.M	99	11	110	2	2	2	\$7,058.00
Madison	Cameron Bethel	67	41	108	2	2	2	\$7,058.00
Madison	Tougaloo	3	99	102	2	2	2	\$7,058.00
Madison	Fearns Chapel F	14	29	43	2	2	2	\$7,058.00

000

0.00 *

000

0.00 *

32,937.00 +
 31,447.00 +
 27,918.00 +
 26,428.00 +
 23,448.00 +
 21,958.00 +
 18,978.00 +
 18,978.00 +
 18,978.00 +
 17,488.00 +
 15,998.00 +
 15,998.00 +
 15,998.00 +
 14,508.00 +
 13,018.00 +
 13,018.00 +
 13,018.00 +
 11,528.00 +
 11,528.00 +
 11,528.00 +
 11,528.00 +
 10,038.00 +
 10,038.00 +
 10,038.00 +
 10,038.00 +
 8,548.00 +
 8,548.00 +
 8,548.00 +
 8,548.00 +
 8,548.00 +
 7,058.00 +
 7,058.00 +
 7,058.00 +
 7,058.00 +
 7,058.00 +
 7,058.00 +
 7,058.00 +
 7,058.00 +
 7,058.00 +
 7,058.00 +

040

539,698.00 *

000

0.00 *

000

Shelton Vance

From: Charlie Munford <charlie@voting.works>
Sent: Tuesday, August 25, 2020 2:17 PM
To: Shelton Vance; Matt Pasternack
Subject: Re: Election Equipment
Attachments: Madison County Universal BMD.xlsx

CAUTION! External Content. Please use caution when opening attachments and links. Do not provide your username and password if requested.

Mr. Vance,

Attached is a complete quote for a full VotingWorks system for Madison County. I left it in Excel format for you. The first sheet is a pricing total, and the following sheets are the breakdown for county-level equipment, precinct-level equipment, and TRUST support.

One important additional factor to consider in pricing this system against competitors is that the VotingWorks system requires no additional paper ballots other than those that can be printed on demand by you on regular 28lb copy paper, for a paper cost of around \$0.02 per sheet. Most other paper ballot systems require ordering cardstock ballots each year from a certified printer, which typically costs around \$0.42 per ballot. Without universal BMDs, these are required to be pre-ordered in quantities specified by law, often around 75% of registered voters per precinct per election. This expense is eliminated by our system. There are no other hidden fees or charges for our system.

Please call me at 504-717-0884 if you have any questions.

Thank you,
Charlie

On Wed, Aug 19, 2020 at 1:33 PM Shelton Vance <Shelton.Vance@madison-co.com> wrote:

It would be great to have a response by Monday of next week.

SV

From: Charlie Munford <charlie@voting.works>
Sent: Wednesday, August 19, 2020 1:33 PM
To: Shelton Vance <Shelton.Vance@madison-co.com>; Matt Pasternack <matt@voting.works>; Matt Roe

<matt.roe@voting.works>

Subject: Re: Election Equipment

CAUTION! External Content. Please use caution when opening attachments and links. Do not provide your username and password if requested.

Mr. Vance,

Thank you for this request! I really appreciate your including VotingWorks in your procurement process. We would be thrilled to get the chance to work with yet another Mississippi county to update your voting system. I will get with our team and provide you with a full breakdown of the solution we could offer y'all. I may have to get back to you with a couple of questions once we have talked this through. How soon do you need this quote finalized?

Sincerely,

Charlie

On Wed, Aug 19, 2020 at 1:17 PM Shelton Vance <Shelton.Vance@madison-co.com> wrote:

Is it possible for you to provide me with an estimate of what it would cost to implement the following setup with your company's equipment.

33 precinct ballot scanners (similar to ES&S DS200) with backup batter and memory device

10 Tote Bins

14 Ballot Marking Devices and carrying case

I am aware that your system does not interface with ES&S equipment. Further, I understand that your quote must include the equipment and software that will accumulate and report results from the precinct scanners.

Thank you for your assistance. Please advise of any questions that you may have.

Shelton

Shelton Vance, CPA

County Administrator

Madison County

PO Box 608

Canton, MS 39046

601-855-5502 (voice)

601-855-5875 (fax)

--

Charlie Munford

VotingWorks

504-717-0884 cell

charlie@voting.works

--

Charlie Munford

VotingWorks
504-717-0884 cell
charlie@voting.works

Category

Courthouse Equipment

\$44,645

Precinct Equipment

\$578,752

5 Years worth TRUST Service

\$171,675

\$34,335 per year

Courthouse Equip	Unit Cost	Quantity	Total Price
Election Manager	2540	2	5080
Ballot Scanner	7913	5	39565
Total			44645

County	Precinct	2019 - Hoseman	2019 - Hughes	2019 - Total	Precinct	BMD (\$1490)	Encoder (\$826)	(\$1213)	- Universal BMD
Madison	Highland Colony Baptist Church	1982	680	2662	18	26820	2478	3639	\$32,937.00
Madison	Parkway Pentecostal Church	1929	551	2480	17	25330	2478	3639	\$31,447.00
Madison	Ridgeland Recreation Center	1343	1009	2352	16	23840	1652	2426	\$27,918.00
Madison	Fairview MB Church	1374	827	2201	15	22350	1652	2426	\$26,428.00
Madison	Gluckstadt @ St Joe Catholic	1490	606	2096	14	20860	1652	2426	\$24,938.00
Madison	Lake Caroline Clubhouse	1662	284	1946	13	19370	1652	2426	\$23,448.00
Madison	Madison Cultural Center	1300	459	1759	12	17880	1652	2426	\$21,958.00
Madison	Vertical Church	1145	408	1553	10	14900	1652	2426	\$18,978.00
Madison	Trace Ridge Baptist Church	946	499	1445	10	14900	1652	2426	\$18,978.00
Madison	Victory Christian Community	1182	253	1435	10	14900	1652	2426	\$18,978.00
Madison	First Presbyterian Madison	1049	305	1354	9	13410	1652	2426	\$17,488.00
Madison	New Life Baptist Church	1012	218	1230	8	11920	1652	2426	\$15,998.00
Madison	Ridgel'D 1st Methodist Church	745	460	1205	8	11920	1652	2426	\$15,998.00
Madison	China Grove A.M.E. Church	918	222	1140	8	11920	1652	2426	\$15,998.00
Madison	Canton South Liberty Baptist Church	479	602	1081	7	10430	1652	2426	\$14,508.00
Madison	Canton Community Center	159	793	952	6	8940	1652	2426	\$13,018.00
Madison	Twin Lakes Baptist Church	643	303	946	6	8940	1652	2426	\$13,018.00
Madison	Feams Chapel Freewill Baptist	617	278	895	6	8940	1652	2426	\$13,018.00
Madison	Victory Baptist Church	638	176	814	5	7450	1652	2426	\$11,528.00
Madison	Canton Catholic Parish Center	234	563	797	5	7450	1652	2426	\$11,528.00
Madison	Magnolia Heights	241	528	769	5	7450	1652	2426	\$11,528.00
Madison	Colonial Heights Baptist Church	330	392	722	5	7450	1652	2426	\$11,528.00
Madison	Canton Anderson Lodge	57	612	669	4	5960	1652	2426	\$10,038.00
Madison	Northbay Bayview Clubhouse	489	151	640	4	5960	1652	2426	\$10,038.00
Madison	Fellowship Bible Church	234	373	607	4	5960	1652	2426	\$10,038.00
Madison	Pleasant Gift Baptist Church	272	281	553	4	5960	1652	2426	\$10,038.00
Madison	Camden Community Center	92	412	504	3	4470	1652	2426	\$8,548.00
Madison	Farmhaven Fire Station	80	418	498	3	4470	1652	2426	\$8,548.00
Madison	Mark Apartments	192	300	492	3	4470	1652	2426	\$8,548.00
Madison	Pleasant Green M.B. Church	85	367	452	3	4470	1652	2426	\$8,548.00
Madison	Mad. Co. Baptist Family Life Ct	29	421	450	3	4470	1652	2426	\$8,548.00
Madison	Sunnybrook Retirement Village	295	79	374	2	2980	1652	2426	\$7,058.00
Madison	Greater Mt Levi Full Gospel	28	306	334	2	2980	1652	2426	\$7,058.00
Madison	Canton Fire Station #4	84	187	271	2	2980	1652	2426	\$7,058.00
Madison	Mt. Hope M.B. Church	211	43	254	2	2980	1652	2426	\$7,058.00
Madison	Canton Bible Church	22	216	238	2	2980	1652	2426	\$7,058.00
Madison	Franklin Baptist Church	198	9	207	2	2980	1652	2426	\$7,058.00
Madison	Canton National Guard Armory	91	114	205	2	2980	1652	2426	\$7,058.00
Madison	Canton St. Paul Methodist Church	13	98	111	2	2980	1652	2426	\$7,058.00
Madison	Cedar Grove Baptist Church	99	11	110	2	2980	1652	2426	\$7,058.00
Madison	Cameron Bethel M.B. Church	67	41	108	2	2980	1652	2426	\$7,058.00

	Unit Price	Quantity	Total Price
Jurisdiction	2500	1	2500
Precincts	450	43	19350
Registered Voters	0.15	83235	12485
Total			34335

Shelton Vance

From: Dwayne Broxton <dbroxton@hartic.com>
Sent: Monday, August 24, 2020 12:46 PM
To: Shelton Vance
Subject: Hart Verity Voting Solution For Madison County
Attachments: VerityScan.pdf; Madison County, MS - Verity w-Central_V1.pdf; Madison County, MS - Verity_V1.pdf

CAUTION! External Content. Please use caution when opening attachments and links. Do not provide your username and password if requested.

Shelton,

Thank you for your interest and inquiry about our Hart Verity voting system. The decision of purchasing your county's next voting system is one that requires a lot of conversation and solid understanding of election technology to help make a solid decision under normal circumstances. You then toss in a relatively quick turnaround time coupled with the Presidential election and it makes picking the right company even more important. For these reasons I believe Hart is the company best positioned to help Madison county ensure a successful election in less than 3 months. Our service and support of our customers is the best in the industry for ten years running. Please take a look at the link below that shows the simplicity of our system for voters, office staff and poll workers. I have attached the quotes we have discussed, one with a high speed scan and one without. I had a good conversation with our technical solutions manager about your county and does not believe that the central scanning option using a high speed scanner is worth the money. Typically much larger jurisdictions opt for high speed scanners, even with the surge in vote by mail this year. I am also including information about our product and an easy to follow how to vote on our system.

<https://youtu.be/Kx2rrP58ofQ>

One other quick point. We do not require a long term service contract keeping our total cost of ownership down. If you have any question please do not hesitate to give me a call.

Best Regards,
Dwayne



Dwayne Broxton
Regional Sales Director

Hart InterCivic

15500 Wells Port Drive | Austin, TX | 78728

850.322.1300 direct | 800.223.HART

dbroxton@hartic.com | www.hartintercivic.com

This message (including any attachments) is intended only for the use of the individual or entity to which it is addressed and may contain information that is non-public, proprietary, privileged, confidential, and exempt from disclosure under applicable law or may constitute as attorney work product. If you are not the intended recipient, you are hereby notified that any use, dissemination, distribution, or copying of this communication is strictly prohibited. If you have received this communication in error, notify us immediately by telephone and (i) destroy this message if a facsimile or (ii) delete this message immediately if this is an electronic communication. Thank you.



Quote Number
Account Name
Grand Total

00007610
Madison County, MS
\$304,472.00

Item	Description	Unit Price	Quantity	Total Price
Verity Scan	Digital ballot scanner	\$6,100.00	33	\$201,300.00
Verity Ballot Box	Ballot box w/ transport bag and privacy screens included with Verity Scan		33	
Secure Ballot Transport Bag	Bag for easy and secure removal and transport of ballots from ballot box	\$50.00	10	\$500.00
Verity Touch Writer w/ Access	Ballot marking device with accessibility	\$5,300.00	14	\$74,200.00
Verity Accessible Booth	Wheelchair-accessible voting booth w/ transport bag and privacy screens included with Verity Touch Writer w/ Access		14	
Okidata B432dn Printer	Laser printer w/ starter cartridge included with Verity Touch Writer for ballot printing		14	
Printer Stand	Small table for printer included with Verity Touch Writer		14	
Verity Build	Verity Build software; includes Verity Data	\$40,000.00	1	\$40,000.00
Verity Count	Verity Count software	\$13,500.00	1	\$13,500.00
Verity Workstation	Workstation for Verity software w/ 5-year warranty	\$5,900.00	2	\$11,800.00
24" Flat Panel Monitor	Monitor for use with Verity Workstation		2	
Okidata B432dn Printer	Laser printer w/ starter cartridge for report printing	\$380.00	1	\$380.00
Okidata C831 Printer	Ballot printer w/ starter cartridges (1 year warranty)	\$4,000.00	1	\$4,000.00
vDrive	Flash memory card/audio card for use with Verity devices	\$66.00	65	\$4,290.00
Verity Key	Electronic security token	\$109.00	4	\$436.00
Battery Charger, 6 Bay	6-bay charger for Verity voting device battery	\$704.00	2	\$1,408.00
New Implementation Services	Includes training, acceptance testing, project management, and on-site support for the first election on the Verity voting system. Additional services, if required, must be purchased separately.	\$28,000.00	1	\$28,000.00
License and Support	Annual license and support fee		1	
Verity Ballot Box	Digital ballot scanner		33	
Verity Accessible Booth	Ballot marking device with accessibility		14	
Okidata B432dn Printer	Ballot marking device with accessibility		14	
Printer Stand	Ballot marking device with accessibility		14	

Subtotal \$379,814.00
Shipping and Handling (Estimated) \$775.00
Solution Price \$380,589.00



Quote Number	00007610
Account Name	Madison County, MS
Grand Total	\$304,472.00
Special Discount	(\$76,117.00)
Grand Total	\$304,472.00

Bill To P.O. Box 1626
Canton, MS 39046

Ship To 128 W North St.
Canton, MS 39046

Customer Contact

Contact Name Shelton Vance

Email shelton.vance@madison-co.com

Phone (601) 855-5502

General Information

Expiration Date 9/20/2020

Instructions Please fax with signature to or scan and email to dbroxton@hartic.com to order.

Payment Terms Net 30

Terms and Conditions

Subsequent License and Support will be billed annually per contract terms.
Pricing subject to inventory availability at time of quote execution and acceptance.
Taxes will be calculated in conjunction with the Customer based on the final approved price list.

Hart Approval

Prepared By Dwayne Broxton

Title Regional Sales Director

Signature 

Customer Approval

Name: _____

Title: _____

Customer Approval: _____

Date: _____



Verity Scan

Digital Ballot Scanning



exceptionally easy and accurate scanned vote capture

Designed for: Early Voting | Election Day | Vote Centers



Easy.

Versatile.

Trustworthy.

Voters

Quick ballot scanning

Patented, animated arrows show the voter exactly when and where to insert the ballot. There's no wrong way to insert the ballot lengthwise, and Verity Scan reads both sides of the ballot in seconds.

Easy second-chance voting

Easy-to-understand, plain language notices alert voters to possible errors, giving them a second chance to make any corrections.

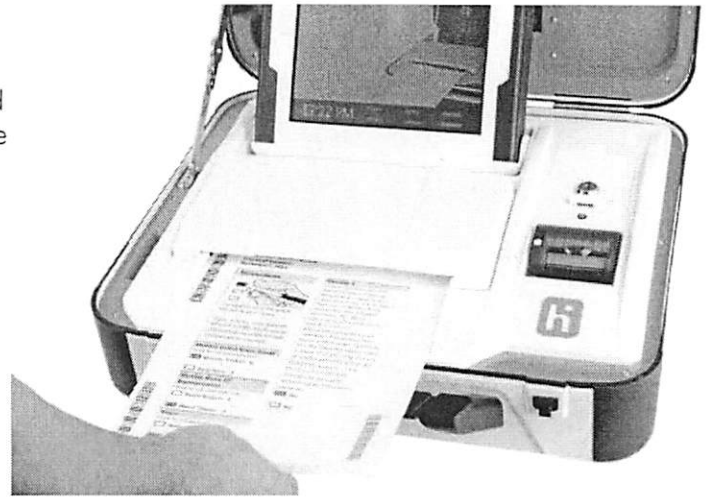

Election Managers

Ensures reliable audits of voter intent and enables fast recounts

You can configure Verity Scan to digitally capture full images of scanned ballots.

Securely stores voting data

Secure, redundant, physically separate storage locations for ballot images, case vote records and audit logs assure officials that voting data is safe.

Provides polling place reports

Built-in thermal printer can print ballot count totals or results at the polling place after polls close.

Enables immediate resolution of write-ins at the polling place

Can print write-in images for on-the-spot write-in resolution.

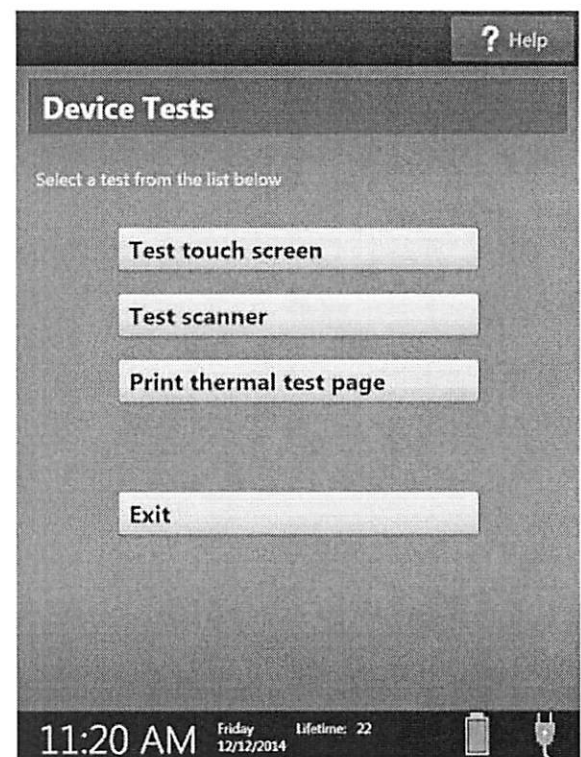

Poll Workers

Easy to transport, set up and use

Verity Scan is easy to transport in ordinary vehicles and easy to set up at the polling place. And the collapsible ballot box folds to just 6 inches thin.

Easy to start up and shut down in minutes

Simple, plain-language, step-by-step onscreen instructions.

Fewer voter questions

Plain-language instructions, animated guide lights, and jam-free ballot feeding means easy scanning for voters – and less work for poll workers.

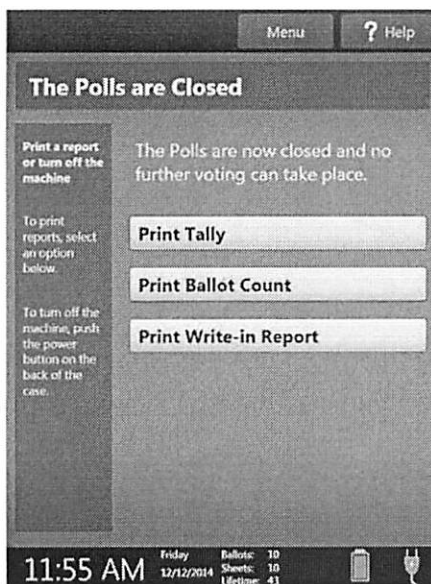

Only Verity uses AIGA Design for Democracy templates; its plain language interface is the easiest to use.

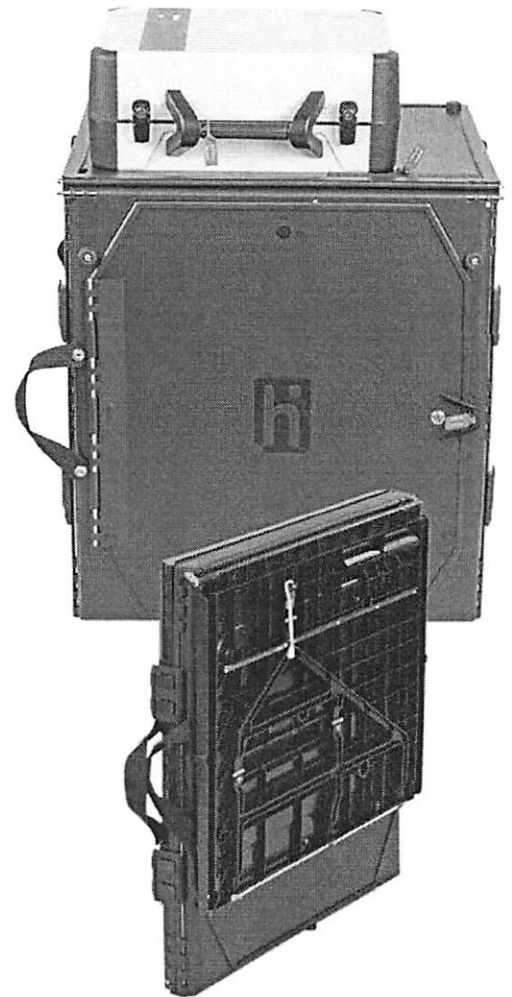

Ballot box folds to 6" thin

Warehouse Staff

Saves on storage space

Verity Scan is compact and stackable, so you use less storage space.

Easy delivery

A small footprint means Verity Scan requires minimal manpower and muscle to deliver.

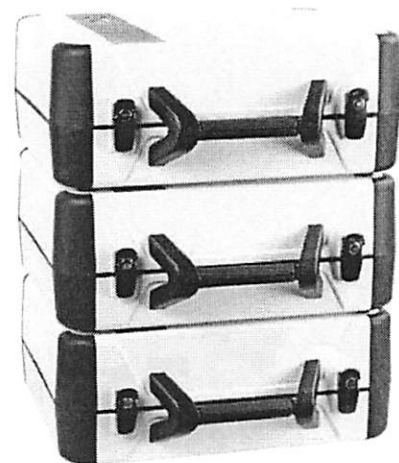

Exceptionally easy to use

With its plain-language, Design for Democracy-based interface and easy-scanning features, Verity Scan is a breeze for voters and poll workers to use.

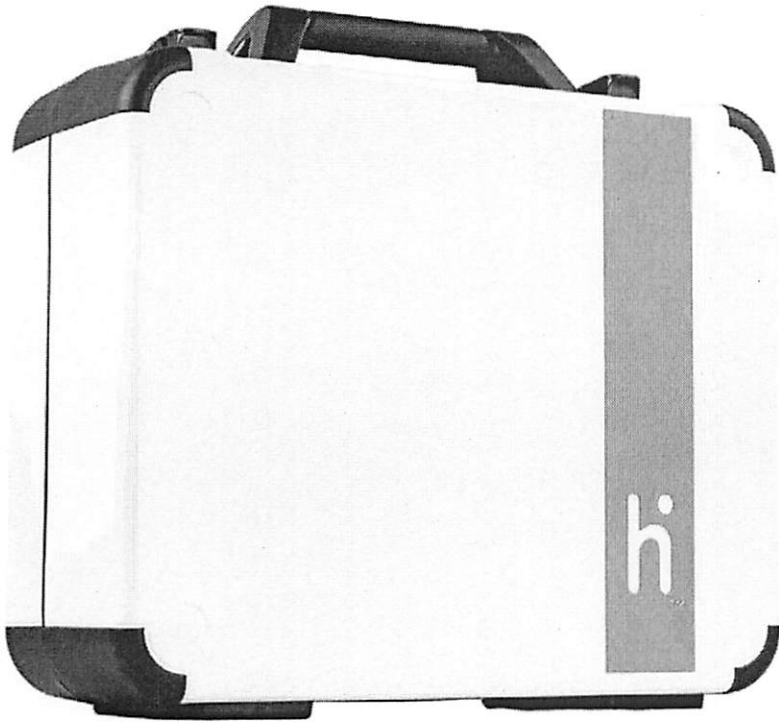

VERITY®

The Future of Elections

Hart InterCivic is a full service election solutions innovator, partnering with state and local governments to deliver the most secure, accurate and reliable elections.

©2016 Hart InterCivic, Inc. Hart InterCivic and Verity are registered trademarks of Hart InterCivic. All rights reserved.



Versatile for long-term value

Verity Scan easily manages hundreds of ballot styles, so you can use it in a large variety of voting scenarios, even if your needs change.

Cost-effective storage, transport and setup

Compact size saves storage space and reduces transportation costs. Easy setup at the polling place can lower staffing costs.

Cost-saving features

With on-board testing and calibration, Verity Scan requires very little maintenance.

Lifecycle longevity

Early in its lifecycle and with a robust new supply chain, Verity Scan promises many, many years of cost-effective service.

This brochure contains marketing information that describes the functional capabilities of Verity products, and is not intended to represent specific implementations for your locale. State- and/or jurisdiction-specific requirements may affect how the products are permitted to be implemented and used.

Shelton Vance

From: Denis Bechac <denis.bechac@smartmatic.com>
Sent: Monday, August 17, 2020 9:30 AM
To: Shelton Vance
Subject: Re: Election Equipment

CAUTION! External Content. Please use caution when opening attachments and links. Do not provide your username and password if requested.

Hey Shelton –

We would love to quote on this opportunity, but are going to have to pass...our solution will not be ready for implementation until mid 2021.

Sincerely,
Denis

From: Shelton Vance <Shelton.Vance@madison-co.com>
Date: Monday, August 17, 2020 at 9:23 AM
To: Denis Bechac <denis.bechac@smartmatic.com>
Subject: RE: Election Equipment

Hello, Denis.

Any update on a quote?

SV

From: Shelton Vance
Sent: Thursday, August 6, 2020 11:04 AM
To: 'Denis Bechac' <denis.bechac@smartmatic.com>
Subject: RE: Election Equipment

The Election Commission is wanting immediate delivery and implementation.

From: Denis Bechac <denis.bechac@smartmatic.com>
Sent: Thursday, August 6, 2020 10:57 AM
To: Shelton Vance <Shelton.Vance@madison-co.com>
Subject: Re: Election Equipment

CAUTION! External Content. Please use caution when opening attachments and links. Do not provide your username and password if requested.

Good morning, Shelton –

It's good to hear from you.

We are looking into a solution for you guys, however, it would be helpful if can share your timeline for implementation. Are you trying to procure and implement for the November 2020 election or will this be for a county election in 2021?

Thanks so much,
Denis



Denis Bechac
Business Development Director
Smartmatic USA
985.264.5556 - Mobile
denis.bechac@smartmatic.com

www.smartmatic.com



From: Shelton Vance <Shelton.Vance@madison-co.com>
Date: Tuesday, August 4, 2020 at 3:12 PM
To: Denis Bechac <denis.bechac@smartmatic.com>
Subject: Election Equipment

Denis,

Thanks for talking with me about election equipment. I appreciate the information that you have shared with me.

Is it possible for you to provide me with an estimate of what it would cost to implement the following setup with your company's equipment.

33 precinct ballot scanners (similar to ES&S DS200) with backup batter and memory device

10 Tote Bins

14 Ballot Marking Devices and carrying case

I am aware that your system does not interface with ES&S equipment. Further, I understand that your quote must include the equipment and software that will accumulate and report results from the precinct scanners.

Thank you for your assistance. Please advise of any questions that you may have.

Shelton

Shelton Vance, CPA
County Administrator
Madison County
PO Box 608
Canton, MS 39046
601-855-5502 (voice)
601-855-5875 (fax)



Generating voter confidence. Enforcing the will of the people.

Madison County, Mississippi - May 2020
Purchase Proposal Quote
Submitted by Election Systems & Software

Purchase Solution Includes:

Quantity	Item Description	Price
Tabulation Hardware		
	Model DS200 Precinct Scanner:	
33	Model DS200 (Includes Scanner, Internal Backup Battery, Plastic Ballot Box with Steel Door and e-Bin, Paper Roll and One (1) Standard 4GB Memory Device)	\$189,750.00
10	DS200 Tote Bin	\$2,250.00
	ExpressVote Ballot Marking Device:	
14	ExpressVote BMD Terminal (Includes Terminal, Internal Backup Battery, ADA Keypad, Headphones, Power Supply with AC Cord, and One (1) Standard 4GB Memory Device)	\$46,550.00
14	Soft-Sided Case	\$2,450.00
Election Services		
X	Equipment Installation	\$5,285.00
X	1 Year Hardware and Software Warranty	Included
	Shipping & Other	
X	Shipping and Handling	\$4,285.00
X	Customer Discount	(\$28,863.50)
	Total Purchase Solution	\$221,686.50

Payment Terms

Amount due within thirty (30) calendar days of contract execution:	\$110,843.25
Amount due within thirty (30) calendar days of delivery of Hardware and/or Software:	\$110,843.25

Annual Post-Warranty License and Maintenance and Support Fees
(Fees are Based Upon a 1-Year Customer Commitment to Subscribe to the Following Services)

Annual Post-Warranty Hardware Maintenance and Support Fees:		
33	HMA DS200 - Extended Warranty with Annual Maintenance	\$6,105.00
14	HMA ExpressVote BMD - Extended Warranty with Annual Maintenance	\$1,680.00
Annual Post-Warranty Firmware License and Maintenance and Support Fees:		
33	Firmware License - DS200	\$2,640.00
14	Firmware License - ExpressVote	\$910.00
	Total Annual Post-Warranty License and Maintenance and Support Fees	\$11,335.00

Footnotes:

1. This quote is an estimate and is subject to final review and approval by both ES&S and the Customer.
2. Rates valid for 60 days and thereafter may change.
3. Any applicable (City & State) sales taxes have not been included in pricing and are the responsibility of the customer.

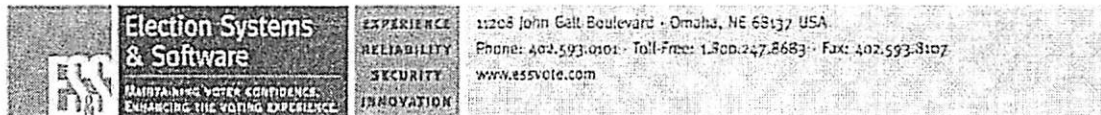

May 28, 2020

Anita Wray
Madison County Circuit Clerk
P. O. Drawer 1626
Canton, MS 39046

**RE: Election Systems & Software, LLC ("ES&S") Equipment, Software
and Support Services**

Dear Ms. Wray:

This letter is in response to Madison County, Mississippi ("County") request for information regarding ES&S' proprietary election equipment, proprietary election software and election support services. This letter provides the County with information on ES&S' proprietary Model DS200® precinct count scanner and ES&S' Proprietary ExpressVote® Ballot Marking Device (the "ES&S Equipment") as well as ES&S' proprietary ES&S Equipment firmware (the "ES&S Software").

Please be advised that ES&S owns all patents, copyrights and trademarks ("Intellectual Property") associated with the ES&S Equipment. As such, ES&S is the sole and exclusive developer and manufacture of the ES&S Equipment and only ES&S may sell the ES&S Equipment in the marketplace. Further, certain component parts of the ES&S Equipment are proprietary to ES&S and may only be obtained directly from ES&S. As certain component (maintenance) parts of the ES&S Equipment may only be obtained directly from ES&S, only ES&S and ES&S trained technicians can ensure that such ES&S proprietary component parts are installed in the ES&S Equipment. This is important to note as all ES&S Equipment certified both at the federal and State level require the replacement of the same certified component parts which were included in the ES&S Equipment at the time such ES&S Equipment was certified. By purchasing the ES&S Equipment from ES&S as well as utilizing ES&S for the performance of preventative and repair maintenance and support services, the County will be assured that all component parts installed in the ES&S Equipment will be in compliance with both the federal and state certified equipment configuration.

With respect to the ES&S Software, please be advised that ES&S is the sole and exclusive developer and licensor of the ES&S Software. As such, ES&S owns all Intellectual Property in its proprietary ES&S Software. Further only ES&S can provide help desk support services for the ES&S Software as well as provide any and all upgrades, enhancements, maintenance patches and other changes to the ES&S Software as may be required by ES&S or its customers. No other vendor in

Anita Wray
May 28, 2020
Page: 2

the marketplace today is authorized to license or provide maintenance and support services for the ES&S Software.

With respect to the County's purchase of additional ES&S Equipment, please be advised that such add on ES&S Equipment will work seamlessly and in conjunction with the County's current ES&S DS200 and ExpressVote units.

Please let me know if you have any questions or need any additional information.

Sincerely,

A handwritten signature in black ink, appearing to read "T. Hallett", with a horizontal line above the first few letters.

Timothy J. Hallett
Associate General Counsel

cc: Bill Lowe, ES&S